

Entresol

URBAN **HUB**

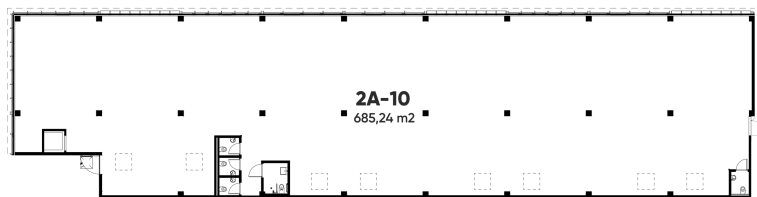

2A-10 Reserved



Total area

685,24 m²

Antresolės plotas

685,24 m²

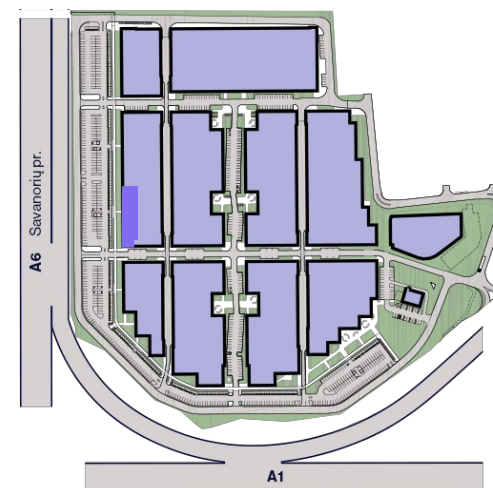

The premises can be connected, and partitions can be installed according to your business needs.

Rokas Adžgauskas

+370 607 25 188

rokas.adzgauskas@urbanhub.lt

urbanhub.lt

Veterinarių g. 4, Kauno r.