

# 6 Reserved

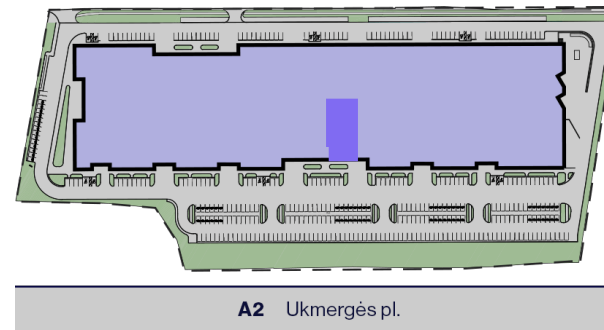

<b>Total area</b>	774,56 m <sup>2</sup>
<b>First floor area</b>	603,71 m <sup>2</sup>
<b>Antresolės plotas</b>	170,85 m <sup>2</sup>

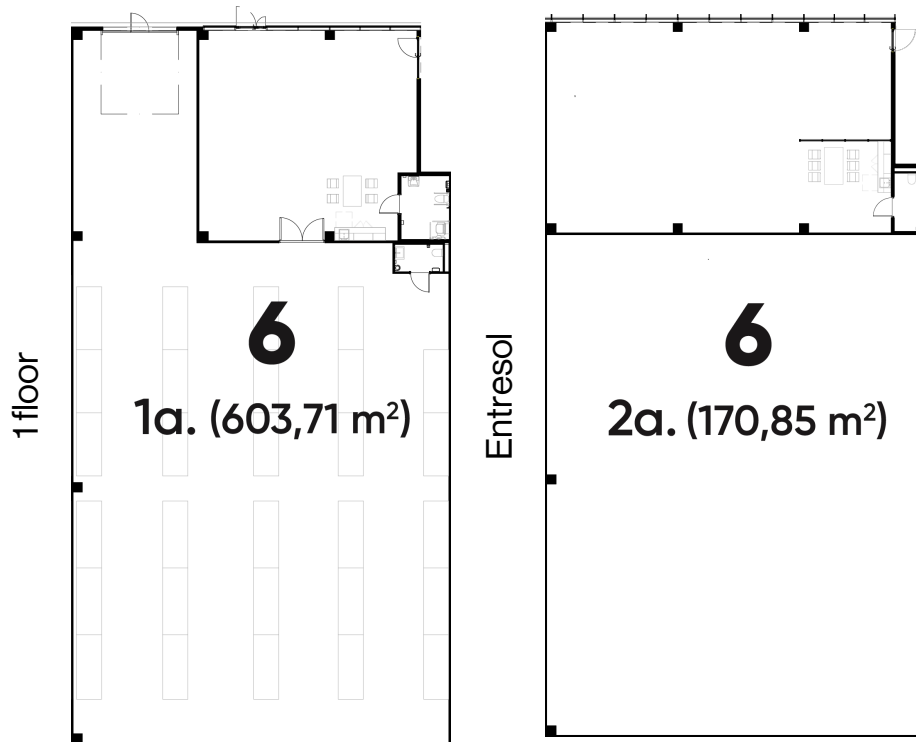

The premises can be connected, and partitions can be installed according to your business needs.

**Lina Zamalytė-Krikščiūnienė**

lina.kriksciuniene@urbanhub.lt

urbanhub.lt

Ožiarūčių g. 3, Vilnius